

MODEL FP3000



FRESCAPURE™

DRINKING WATER SYSTEMS



USE & CARE MANUAL



System tested and certified by NSF International against NSF/ANSI Standard 42 for the reduction of Chlorine Taste and Odor, nominal particulate Class I and NSF/ANSI Standard 53 for the reduction of Lead MTBE.

See performance data sheet for individual contaminants and reduction performance.

Questions or Comments: 1-800-279-3373
8am-5pm Central Standard Time

IMPORTANT: *Read and Save these Instructions*

TABLE OF CONTENTS

INTRODUCTION	1
IMPORTANT USE GUIDELINES.....	1
OPERATING INSTRUCTIONS	2
REPLACEMENT PARTS DIRECTORY	3
SETUP AND INSTALLATION	3
REPLACING THE CARTRIDGE.....	4
TROUBLESHOOTING.....	6
WARRANTY	9

INTRODUCTION

Congratulations on the purchase of your new, FrescaPure™ 3000 Drinking Water System!

You have taken an important step toward improving the quality of your drinking and cooking water. This System takes just a few minutes to install in your home, cabin, RV, dorm room, or boat.

This System is designed to serve you reliably for many years to come when operated and maintained according to the directions contained in this manual. You have made a wise investment in providing quality drinking water for you, and your loved ones. Now, please take a few, additional minutes to insure that you realize all of the benefits your new system has to offer.

IMPORTANT USE GUIDELINES

1. Replacement cartridges may be purchased from your Independent, Royal Prestige Representative, for purchase information you may also call the Royal Prestige Customer Service Center at 1-800-279-3373.
2. Actual capacity of your Cartridge may vary from the rated capacity. This may be due to the volume of contaminants actually present in your water supply. Replace the Cartridge:
 - Annually
 - The flow rate diminishes
 - When the rated capacity of the cartridge has been reached
 - When you notice a taste or odor re-occurrence
3. Read this manual completely before attempting to install or use this product.
4. Do not use with water that is microbiologically unsafe or of unknown quality without adequate disinfection before or after the System.
5. Individuals requiring specific microbiological purity should consult their physician.
6. For use on cold potable water supplies only.
7. For this System to continue to perform as tested and represented, use only Genuine, Royal Prestige NSF Certified Replacement Cartridges (RC-30-FP).



8. Do not allow System to sit for extended lengths of time without being used (*10 days or more*). If System must be left unused for more than 10 days, drain all water from the System and remove the Cartridge. Once you return, re-install Cartridge and continue to use. In the event System is not used for 10 days or more, the System should be flushed for fifteen minutes prior to use.
9. This System must be protected from freezing, failure to do so may result in loss of performance, damage to the parts and water leakage. If System is exposed to freezing temperatures, drain water from Filter Housing and remove Cartridge.
10. Installation of this product must comply with all state and local laws and regulations. Refer to your local agencies for details.
11. The contaminants or other substances removed or reduced by this product are not necessarily in all user's water.

OPERATING SPECIFICATIONS

Model #	FP3000
Installation	Counter-top
EPA Establishment Number	63018-NV-001
Rated Capacity	480 gallons (3028 Liters)
Replacement Cartridge	RC-30-FP
Rated Service flow	0.75 gal/min
Housing Construction	Surgical Stainless Steel High Impact ABS
Maximum Working Pressure	100 psig(689.5 kPa)
Minimum Working Pressure	30 psig(206.8 kPa)
Maximum Operating Temperature	100 F°/ 38° C
Minimum Operating Temperature	32° F/ 0° C

REPLACEMENT PARTS DIRECTORY

FRESCAPURE™ 3000

ITEM	PART NUMBER	DESCRIPTION
1	1215-10-01	Cap Assembly
2	9-904-0066	Cartridge
3	1215-10-02	Housing Assembly
4	0531-50-05	3/8" Diverter Assembly
5	9-904-0023	3 piece Faucet Adapter Kit

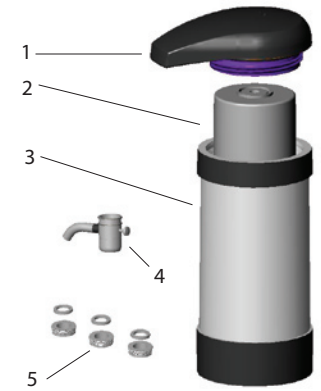

SET UP AND INSTALLATION

1. Open the shipping carton, remove the Drinking Water System and all items and place them on your kitchen counter.
2. Compare them with the parts shown in this manual to be certain all items were included.
3. Remove the aerator from the end of your kitchen faucet, if it has one.
4. Attach Diverter Valve directly onto your kitchen faucet. Do not over-tighten.
5. If the threads to the Diverter Valve do not directly attach to your kitchen faucet, use one of the three Adapters provided.
6. Most kitchen faucets with external threads will directly attach to the Diverter Valve. In some instances the Diverter Valve may be smaller than your kitchen faucet. In this case use the Adapter with internal threads and attach it directly to your kitchen faucet. Next, attach the Diverter Valve to the Adapter.
7. If your kitchen faucet has internal threads, attach one of the two Adapters with external threads directly to your kitchen faucet. Next, attach the Diverter Valve to the Adapter.
8. If your kitchen faucet does not have threads, measure the inside diameter of the kitchen faucet and provide this information to your Independent Royal Prestige Representative or to the Royal Prestige Customer Service Center (1-800-279-3373). Be sure to request an expandable adapter.

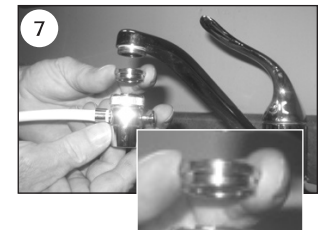

9. If your kitchen faucet does not fit any of the Adapters provided, send the threaded aerator to your Independent, Royal Prestige Representative, or to the Royal Prestige Customer Service Department. Include a note requesting an adapter that fits your threaded aerator.
10. With the System placed on the counter next to your sink, turn the cold water "on" and pull the Diverter Pin. Water will begin entering the Filter Housing. Check to see that all hose, clamp and housing connections are tight and do not leak.
11. When using your System for the first time, allow the System to flush into the sink for fifteen (15) minutes. This will remove any fine, black carbon particles left over from the manufacturing process, expel trapped air, and will condition the Cartridge for normal use. This procedure should be repeated each time a new Cartridge is installed.

REPLACING THE CARTRIDGE

The most important part of maintaining your FrescaPure™ 3000 Drinking Water System is replacing the Cartridge on a regular service interval. To insure that your System continues to perform as tested and represented in the Performance Data Sheet, the Cartridge should be replaced every twelve (12) months, when you notice a reduction in flow, when the rated capacity of the Cartridge has been reached, or whenever there is a taste or odor re-occurrence, whichever comes first.

IMPORTANT: Be sure to insist on Genuine, Royal Prestige NSF Certified Replacement Cartridges. All Royal Prestige Genuine Replacement Cartridges can be identified by the Royal Prestige Registered Trademark which appears on every Genuine Royal Prestige NSF Certified Cartridge.

Only Genuine Royal Prestige NSF Listed Replacement Cartridges have been tested and certified to insure the performance represented in the Performance Data Sheet. Failure to use Genuine, Royal Prestige Replacement Cartridges and replacement components will invalidate your warranty.



1. Remove the Lid Assembly by turning counterclockwise until it separates from the Filter Housing. As you remove the Lid Assembly, the Cartridge will remain attached to the Lid Assembly.



RECOMMENDATION: Rubber gloves should be worn to avoid direct contact with the contaminants removed by the used Cartridge.

2. Hold the Lid Assembly and rotate the Cartridge counterclockwise to remove. Discard the old cartridge with your regular refuse.
3. Wash the inside of the Filter Housing and Lid Assembly with warm water, a mild dish washing detergent, and a clean cloth.

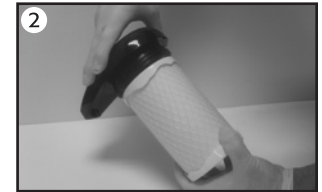

CAUTION: Do not use abrasive pads or other abrasive materials to clean the Filter Housing or Lid Assembly.

4. Remove the sanitary plastic wrap from the new Cartridge. Thread the new Cartridge clockwise onto the threaded post on Lid Assembly until you feel resistance. Make an additional quarter turn. Do not Over-Tighten.
5. Thread Lid Assembly clockwise onto Filter Housing until tightened.
6. Depending upon whether you locate your FrescaPure™ 3000 Drinking Water System to the right or left of your kitchen sink, the tubing from the Diverter Valve will press fit into slot located at either side of Filter Housing.

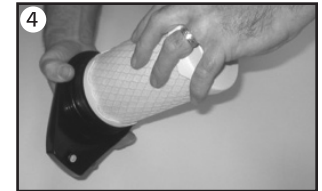

7. Position Spout so that water will flow into kitchen sink. Turn the cold water faucet "on" and pull Diverter Pin. Water will begin filling the Filter Housing.
8. Allow the System to flush into the sink for fifteen (15) minutes. This will remove any fine, black carbon particles left over from the manufacturing process, expel trapped air, and condition the Cartridge for normal use. This procedure should be repeated each time a new cartridge is installed.



Congratulations! Your FrescaPure™ 3000 Drinking Water System is now ready for use.



TROUBLESHOOTING

Condition:

White sediment is in my filtered water.

Reason:

There is a presence of calcium carbonate in your main water supply. This will occur any time the filtered water is boiled or frozen and then melts.

Solution:

This condition is normal and no action is required.

Condition:

Ice cubes appear cloudy in the center.

Reason:

Minerals such as calcium and magnesium that are present in your water supply collect in the center of the ice cubes when water is frozen. Your System is designed specifically to leave beneficial trace minerals in your water.

Solution:

No action is required.

Condition:

Filtered water is flowing slowly from the System.

Reason:

Excessive amounts of particles in the water supply may have caused pre-mature plugging of the Cartridge.

Solution:

The Cartridge must be replaced due to poor water quality conditions in your area.

Condition:

Diverter Pin is sluggish or does not fully return to the "Off" position after being in service for a while.

Reason:

There could be a lack of lubricant on the shaft of the Diverter Valve. Remove the Diverter Valve from the faucet. Press petroleum jelly into the opening on the Diverter Valve. Work the Diverter Pin in and out until a

smooth motion is restored.

Hard water (water with high content of dissolved minerals) has caused a build-up of scale in the Diverter Valve. Detach the Diverter Valve from the kitchen faucet. Remove the rubber washer inside Diverter Valve and soak Diverter Valve in vinegar for several hours to remove scale build-up. Then rinse the Diverter Valve with warm water. Press petroleum jelly into opening on the Diverter Valve and work the Diverter Pin in and out until a smooth action is restored. Replace rubber washer and re-connect the Diverter Valve to the kitchen faucet.

NOTE: Genuine Royal Prestige NSF Listed Replacement Cartridge's may be purchased from your Independent Royal Prestige Representative you can also call the Royal Prestige Customer Service Center at: 1-800-279-3373.



NOTES:



**Limited Warranty
For Royal Prestige® Brand Products**

**Royal Prestige
FrescaPure™ 3000
Model FP3000**

Hy Cite Corporation ("Hy Cite") provides the following warranties on its Royal Prestige product line to the original consumer owner of the product, whether obtained by purchase or by gift.

Hy Cite warrants that the base assembly, filter housing and spout assembly of your Royal Prestige FrescaPure 3000 Water Filter will be free from defects in material and workmanship for 15 years from the date of purchase. Hy Cite also warrants that your Water Filter cartridges will not become clogged for 90 days from the date of purchase.

Note: Maintenance parts for your Water Filters (including Diverter Valve and Hose Assembly, and Rubber O-Rings) may need replacement, not because of defects, but because hard water minerals may clog valves and harsh chemicals in tap water can cause Rubber O-Rings and hoses to become brittle. Maintenance parts may be replaced at one-half (50%) of the current retail price during the 15 year warranty period.

Limitations on Coverage: The Hy Cite warranties cover only normal household use and shall be void if your covered product has been damaged by accident, unreasonably used or misused, abused, neglected, improperly assembled, maintained or serviced, used for commercial purposes, or repaired by unauthorized persons.

Implied Warranties: ANY IMPLIED WARRANTIES WHICH THE PURCHASER MAY HAVE ARE LIMITED IN DURATION TO THE SAME DURATION AS THE WRITTEN WARRANTY DESCRIBED ABOVE FOR YOUR COVERED PRODUCT. Some states do not allow limitations on how long an implied warranty lasts, accordingly, the above limitation may not apply to you.

Warranty Performance: Should your covered product not comply with our warranty, return it to Hy Cite postage prepaid and Hy Cite will, at its option, either repair or replace the product. Hy Cite may replace the product with any equivalent product or with a product incorporating a new technology or design.

Return of Product: To obtain warranty service, return the product to our Service Center:

Hy Cite Corporation
Royal Prestige Service Center
2115 Pinehurst Drive
Middleton, WI 53562
1-800-279-3373

Please do not return used cartridges to Royal Prestige unless they become defective or clogged within the 90-day warranty period.

Damage in Shipment: Hy Cite will replace any covered product damaged in shipment free of charge if you notify Hy Cite within 30 days after your receipt of the product. Simply contact the Royal Prestige Service Center. As a condition to replacement, Hy Cite may require you to make the damaged product available for pick-up at Hy Cite's expense.

Purchase Option: If your covered product is damaged by fire or storm, or is stolen, you may purchase new replacement product at one-half (50%) of current retail price. A valid police or fire report is required for discounted purchase.

Limitation of Remedies: No representative or other person is authorized to assume for Hy Cite any other liability in connection with the sale of covered products. Repair or replacement, at Hy Cite's option, shall be your remedy under this warranty and in no event shall Hy Cite be liable for any incidental or consequential damages, losses or expenses. Some states do not allow the exclusion or limitation of incidental or consequential damages, accordingly, the above limitation may not apply to you.

Legal Rights: This warranty gives you specific legal rights, and you may also have other rights which vary from State to State.

For more information on Hy Cite's Royal Prestige brand products, visit our website:
www.royalprestige.com

Legal.388v8

11/06

*Due to continuing product development and research,
final specification and/or appearance may vary.*



Exclusively distributed by:

ROYAL PRESTIGE

2115 Pinehurst Drive, Middleton, WI 53562-2528

www.RoyalPrestige.com • © 2006 Royal Prestige • Printed in USA

Reproduction of this printed material is prohibited

1-400-0110